

# HSF

**NOTES:**

Rated Current: 3.0AMP.(20°C, 2\*2P-2\*15P)  
 2.0AMP.(20°C, 2\*16P-2\*40P)  $\Delta_{33}$   
 Contact Resistance: 20mΩ Max.  
 Withstand Voltage: 500V AC/DC  
 Insulation Resistance: 1000MΩ Min.  
 Operation Temperature: -40°C to +125°C(Gold Plating)  
 -40°C to +105°C(Tin Plating)  $\Delta_{33}$

Contact Material: Copper Alloy  
 Contact Plating: Au or Sn Over 30u" Min Ni  $\Delta_{33}$   
 Insulator Material: PA9T+G.F UL94V-0 BK

## Ordering Information

1220- 1 2 XX XX Z XXX C R XX  $\Delta_{33}$

Plastic Layer  
 Plastic Row  
 No. of Pins  
 Per Row: 02-40  
 Contact Plating  
 G0=Gold Flash  
 G3=10u"Au, BG3=8u"PdNi+2u"Au  
 G4=15u"Au, BG4=13u"PdNi+2u"Au  
 G5=30u"Au, BG5=28u"PdNi+2u"Au  
 S0=Gold Flash/Tin  
 S3=10u"Au/Sn, P3=8u"PdNi+2u"Au/Sn  
 S4=15u"Au/Sn, P4=13u"PdNi+2u"Au/Sn  
 S5=30u"Au/Sn, P5=28u"PdNi+2u"Au/Sn  
 SN=Bright Tin  
 SM=Matte Tin

Series No.  
 01-99  
 Packing  
 T=Tube  
 P=Tube+CAP  
 R=Tape & Reel+CAP  
 Insulator Material  
 C=PA9T  
 Pin Length  
 L(See Table)  
 Type:  
 Z:R/A SMT

Item	Pin Length	A1	A	B	Mating
Standard	7.5/10.8	2.80	6.22	2.5	2220T/2221/2228
	7.8/17.3			3.0	2227T/2228T/2245
	8.5/22.5			3.5	2235/2240N/2243C
	9.0/22.8			4.0	2240/2243/2245T/2263/2272
Alternate					

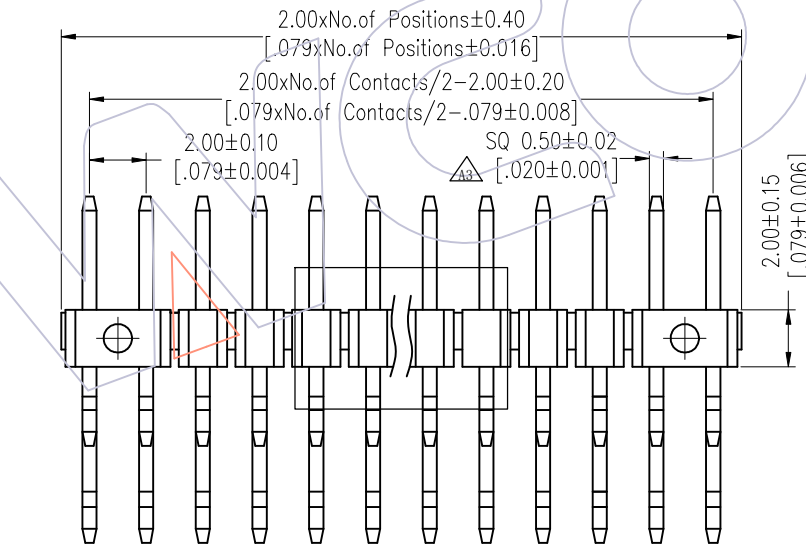
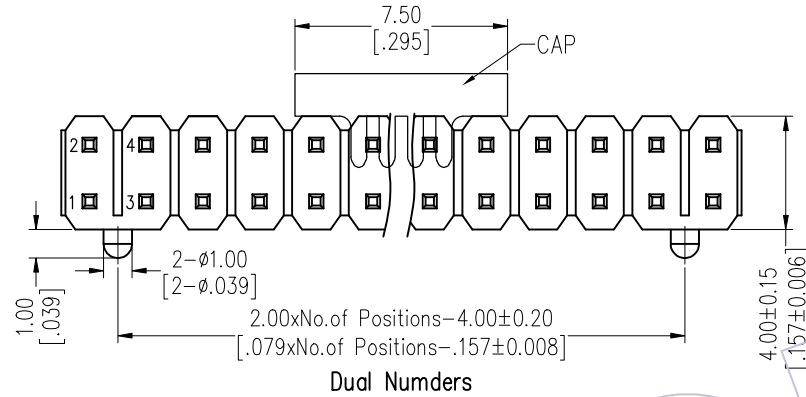

PIN	2-15P	16-25P	26-40P
M	0.10	0.15	0.25

Recommended P.C.B Layout (Top Side)  
 (PCB BOARD TOLERANCE±0.05)  
 (PCB Thickness: T=1.60m)

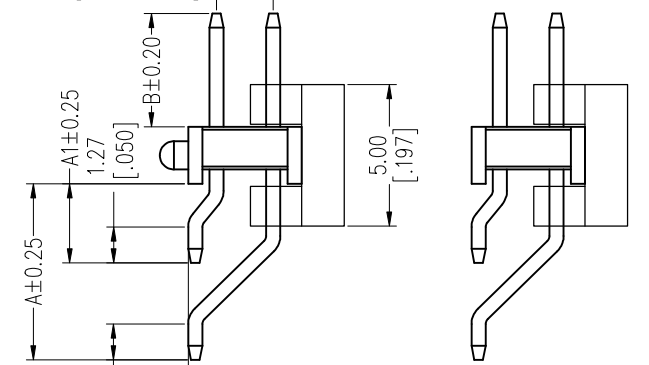
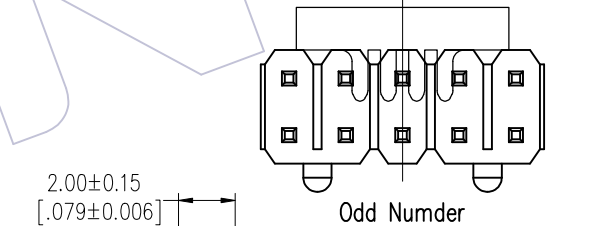
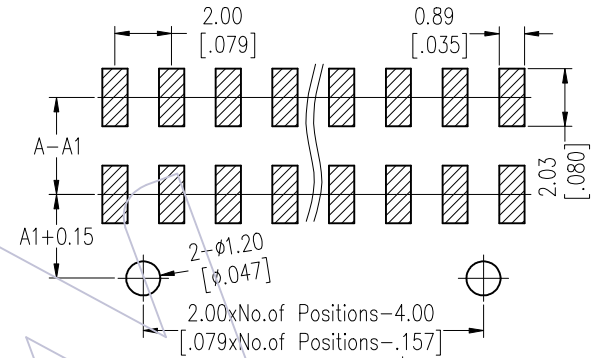

REV	DATE	MODIFICATION DESCRIPTION	CHANGE	OPERATION	DRAW	DATE	SCALE	Fit	PART NO.
A3	2025/04/11	Standardization Drawing	CP	OPERATION	DRAW	2025/04/11	SCALE	Fit	1220-12XXXXZXXXCRXX $\Delta_{33}$
A2	2018/09/07	Modify	Ding	x.X ±0.40	CP	2025/04/11	UNIT	mm	TITLE: PH2.00 DUAL ROW 90° SMT H=2.0
A1	2018/01/19	Modify P/N	Liu	x.XX ±0.25	CHECK	2025/04/11	SIZE	A4	
A0	2012/04/26	NEW	William Chen	x.XXX ±0.15	TANG	2025/04/11	SHEET	1/4	
REV	DATE	MODIFICATION DESCRIPTION	CHANGE	Angle ± 3°	APPROVE	DATE	SHEET	1/4	Customer NO.
				DIM TOL	Steven Zhao	2025/04/11	PROJ.		

**WCON**  
 Http: www.wcon.com

WCON-Dongguan  
 Tel: +86 769 85358920  
 Fax: +86 769 85358915  
 E-mail: sales@wcon.com

WCON-Kunshan  
 Tel: +86 512 57468408  
 Fax: +86 512 57468468  
 E-mail: sales@wcon.com



**HSF**

**Packaging Quantity Refers To The Following Table**

W/O CAP

PINS /Row	Q'ty/Tube	Q'ty/Inner Box	Q'ty/Box
4	72	5,760	11,520
5	58	4,640	9,280
6	48	3,840	7,680
7	41	3,280	6,560
8	36	2,880	5,760
9	32	2,560	5,120
10	29	2,320	4,640
11	26	2,080	4,160
12	24	1,920	3,840
13	22	1,760	3,520
14	20	1,600	3,200
15	19	1,520	3,040
16	18	1,440	2,880
17	16	1,280	2,560
18	15	1,200	2,400
19	15	1,200	2,400
20	14	1,120	2,240
21	13	1,040	2,080
22	13	1,040	2,080

W/O CAP

PINS /Row	Q'ty/Tube	Q'ty/Inner Box	Q'ty/Box
23	12	960	1,920
24	11	880	1,760
25	11	880	1,760
26	11	880	1,760
27	10	800	1,600
28	10	800	1,600
29	9	720	1,440
30	9	720	1,440
31	9	720	1,440
32	9	720	1,440
33	8	640	1,280
34	8	640	1,280
35	8	640	1,280
36	8	640	1,280
37	7	560	1,120
38	7	560	1,120
39	7	560	1,120
40	7	560	1,120

W/T CAP

PINS /Row	Q'ty/Tube	Q'ty/Inner Box	Q'ty/Box
4	72	7,200	14,400
5	58	5,800	11,600
6	48	4,800	9,600
7	41	4,100	8,200
8	36	3,600	7,200
9	32	3,200	6,400
10	29	2,900	5,800
11	26	2,600	5,200
12	24	2,400	4,800
13	22	2,200	4,400
14	20	2,000	4,000
15	19	1,900	3,800
16	18	1,800	3,600
17	16	1,600	3,200
18	15	1,500	3,000
19	15	1,500	3,000
20	14	1,400	2,800
21	13	1,300	2,600
22	13	1,300	2,600

W/T CAP

PINS /Row	Q'ty/Tube	Q'ty/Inner Box	Q'ty/Box
23	12	1,200	2,400
24	11	1,100	2,200
25	11	1,100	2,200
26	11	1,100	2,200
27	10	1,000	2,000
28	10	1,000	2,000
29	9	900	1,800
30	9	900	1,800
31	9	900	1,800
32	9	900	1,800
33	8	800	1,600
34	8	800	1,600
35	8	800	1,600
36	8	800	1,600
37	7	700	1,400
38	7	700	1,400
39	7	700	1,400
40	7	700	1,400

A3	2025/04/11	Standardization Drawing	CP	OPERATION	DRAW	DATE	SCALE	Fit	PART NO.
A2	2018/09/07	Modify	Ding	x.x ±0.40	CP	2025/04/11	UNIT	mm	1220-12XXXXXXCRXX
A1	2018/01/19	Modify P/N	Liu	x.xx ±0.25	CHECK	DATE	SIZE	A4	TITLE:
A0	2012/04/26	NEW	William Chen	x.xxx ±0.15	TANG	2025/04/11	SHEET	3/4	PH2.00 DUAL ROW 90° SMT H=2.0
REV	DATE	MODIFICATION DESCRIPTION	CHANGE	Angle ± 3°	APPROVE	DATE	PROJ.		Customer NO.
				DIM TOL	Steven Zhao	2025/04/11			

**WCON**  
 Http: www.wcon.com

WCON-Dongguan  
 Tel: +86 769 85358920  
 Fax: +86 769 85358915  
 E-mail: sales@wcon.com

WCON-Kunshan  
 Tel: +86 512 57468408  
 Fax: +86 512 57468468  
 E-mail: salesks@wcon.com

**HSF**

**Packaging Quantity Refers To The Following Table**

B=2.5/3.0/3.5

B=2.5/3.0/3.5

B=4.0

B=4.0

PINS /Row	W	Q'ty/Reel	Q'ty/Inner Box	Q'ty/Box
2	16	550	2,200	6,600
3	16	550	1,650	4,950
4	24	550	1,650	4,950
5	24	550	1,650	4,950
6	24	550	1,650	4,950
7	24	550	1,650	4,950
8	32	550	1,100	3,300
9	32	550	1,100	3,300
10	44	550	1,100	3,300
11	44	550	1,100	3,300
12	44	550	1,100	3,300
13	44	550	1,100	3,300
14	44	550	1,100	3,300
15	44	550	1,100	3,300
16	56	550	550	1,650
17	56	550	550	1,650
18	56	550	550	1,650

PINS /Row	W	Q'ty/Reel	Q'ty/Inner Box	Q'ty/Box
19	56	550	550	1,650
20	56	550	550	1,650
21	56	550	550	1,650
22	72	550	550	1,650
23	72	550	550	1,650
24	72	550	550	1,650
25	72	550	550	1,650
26	72	550	550	1,650
27	72	550	550	1,650
28	72	550	550	1,650
29	72	550	550	1,650
30	88	550	550	1,650
31	88	550	550	1,650
32	88	550	550	1,650
33	88	550	550	1,650
34	88	550	550	1,650
35	88	550	550	1,650

PINS /Row	W	Q'ty/Reel	Q'ty/Inner Box	Q'ty/Box
2	16	450	1,800	5,400
3	16	450	1,800	5,400
4	24	450	1,350	4,050
5	24	450	1,650	4,950
6	24	450	1,650	4,950
7	24	450	1,650	4,950
8	32	450	900	2,700
9	32	450	900	2,700
10	44	450	900	2,700
11	44	450	900	2,700
12	44	450	900	2,700
13	44	450	900	2,700
14	44	450	900	2,700
15	44	450	900	2,700
16	56	450	450	1,350
17	56	450	450	1,350
18	56	450	450	1,350

PINS /Row	W	Q'ty/Reel	Q'ty/Inner Box	Q'ty/Box
19	56	450	450	1,350
20	56	450	450	1,350
21	56	450	450	1,350
22	72	450	450	1,350
23	72	450	450	1,350
24	72	450	450	1,350
25	72	450	450	1,350
26	72	450	450	1,350
27	72	450	450	1,350
28	72	450	450	1,350
29	72	450	450	1,350
30	88	450	450	1,350
31	88	450	450	1,350
32	88	450	450	1,350
33	88	450	450	1,350
34	88	450	450	1,350
35	88	450	450	1,350

A3	2025/04/11	Standardization Drawing	CP	OPERATION	DRAW	DATE	SCALE	Fit	PART NO.
A2	2018/09/07	Modify	Ding	x.X ±0.40	CP	2025/04/11	UNIT	mm	1220-12XXXXXXCRXX
A1	2018/01/19	Modify P/N	Liu	x.xx ±0.25	CHECK	DATE	SIZE	A4	TITLE:
A0	2012/04/26	NEW	William Chen	x.xxx ±0.15	TANG	2025/04/11	SHEET	4/4	PH2.00 DUAL ROW 90° SMT H=2.0
REV	DATE	MODIFICATION DESCRIPTION	CHANGE	Angle ± 3'	APPROVE	DATE	PROJ.		Customer NO.
				DIM TOL	Steven Zhao	2025/04/11			

**WCON**  
 Http: www.wcon.com

WCON-Dongguan  
 Tel: +86 769 85358920  
 Fax: +86 769 85358915  
 E-mail: sales@wcon.com

WCON-Kunshan  
 Tel: +86 512 57468408  
 Fax: +86 512 57468468  
 E-mail: salesks@wcon.com