

# HSF

**NOTES:**

Current Rating: 1AMP  
 Contact Resistance: 30mΩ max  
 Withstand Voltage: 250V AC/DC  
 Insulation Resistance: 1000MΩ min  
 Operation Temperature: -40°C to +105°C

Contact Material: Phosphor  
 Bronze(C5191-H)  
 Contact plating: Au Or Sn Over Ni  
 Insulator Material: PA9T+30%GF(UL94V-0)

Recommended P.C.B Layout(Top Side)  
 (PCB BOARD TOLERANCE±0.05)

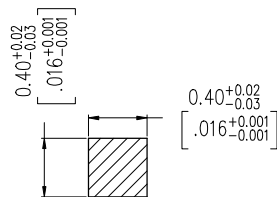
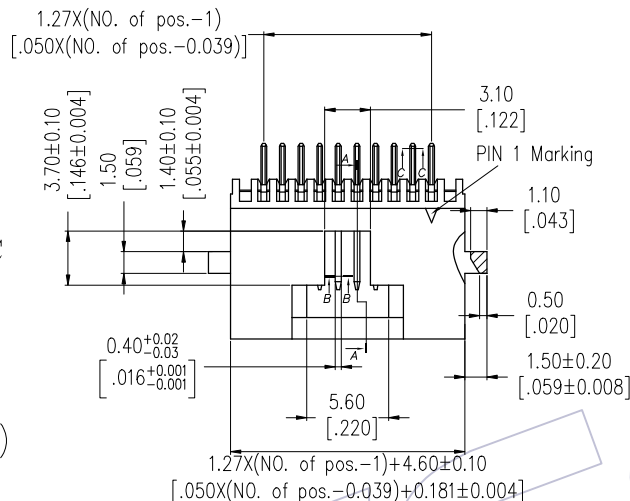

SECTION B-B  
 SCALE 10:1

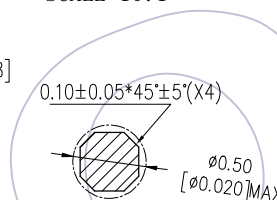

SECTION C-C  
 SCALE 10:1

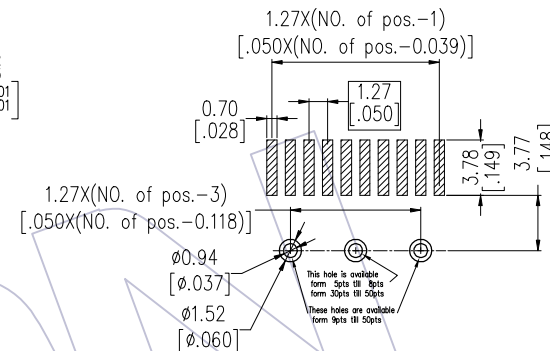

**Ordering Information**

WF1271-1 WZ H XX S0 B T 0

No. of Pins  
 4-50 PIN

Contact Plating  
 S0=Gold Flash/Tin

Packing:  
 T=Tube

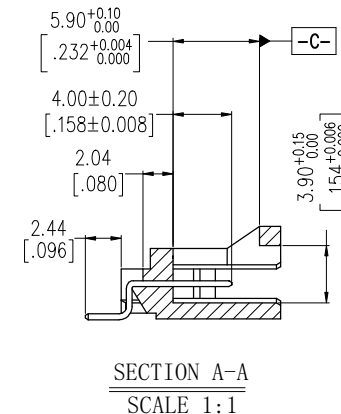
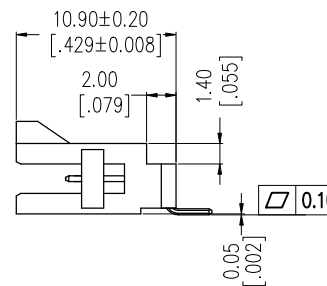
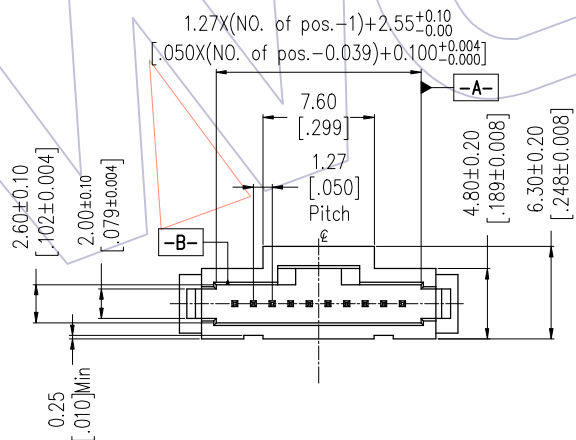

REV	DATE	MODIFICATION DESCRIPTION	CHANGE	OPERATION		DRAW	DATE	SCALE	FIT	PART NO.	TITLE:	Customer NO.	WCON Http: www.wcon.com
				X.X	±0.40								
AO	2016/07/17	NEW	---	X.XX	±0.25	CHECK	DATE	SIZE	A4	1.27 Wafer Conn 90° SMT With Ear	1/1	Tel: +86 769 85358920 Fax: +86 769 85358915 E-mail: sales@wcon.com	Tel: +86 512 57468408 Fax: +86 512 57468468 E-mail: salesks@wcon.com
				X.XXX	±0.15	APPROVE	DATE	SHEET					
				Angle	± 3'	PROJ.							
				DIM	TOL								